

## AXOR Uno

**Electronic basin mixer for concealed installation wall-mounted with spout 225 mm**

Surfaces: **Stainless Steel Optic** Article Number: **38120800**



### Description

#### product features

- projection 225 mm
- normal spray
- flow rate at 3 bar: 5 l/min
- theft-proof aerator
- temperature adjustable via iBox
- infrared sensor technology
- automatic environmental adjustment of infrared sensor
- adjustable optical range of infrared sensor (5 settings)
- 230 V / 50 Hz mains connection
- manual water stop for washbasin cleaning
- for ideal function please note a minimum distance of 140 mm from the aerators center to the back rim of the wash basin
- TÜV certified
- dirt filters in the connection hoses
- SVGW 1209-6079
- PA-IX 19804/IO
- ETA VA 1.42/20197
- GDV 04/00120
- ACS 17 ACC NY 156, valide jusqu'au 27.04.2022
- Kiwa K74521\_Electronic Mixers
- STA 1428

### Technology



## AXOR Uno

Electronic basin mixer for concealed installation wall-mounted with spout 225 mm

Surfaces: **Stainless Steel Optic** Article Number: **38120800**



### Product image



### Scale drawing

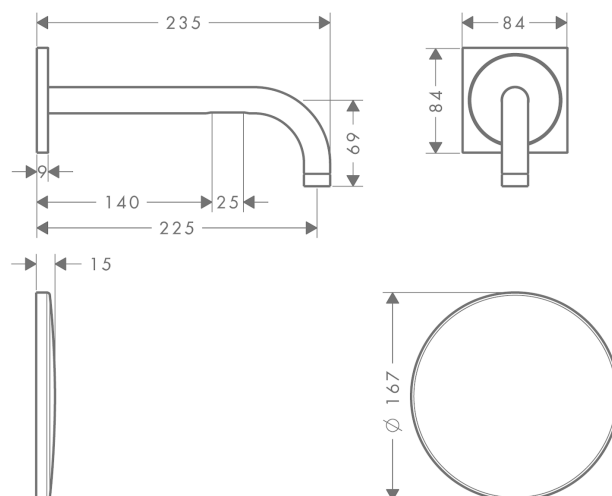

### Flowchart

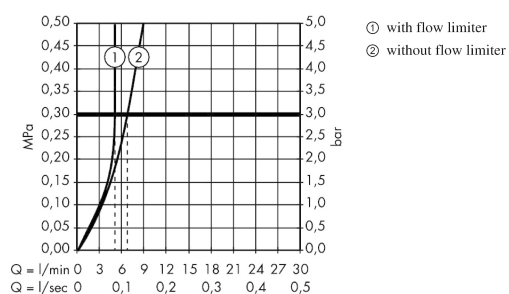

## AXOR Uno

Electronic basin mixer for concealed installation wall-mounted with spout 225 mm

Surfaces: **Stainless Steel Optic** Article Number: **38120800**



### Installation examples

