

## AXOR ShowerSolutions

### Hand shower 120 3jet

Surfaces: **Chrome** Article Number: **26050000**



#### Description

##### product features

- shower head size: 125 mm
- convenient diversion via Select button
- spray type: Rain, RainAir, Whirl
- flow rate at 3 bar: 15 l/min
- with internal water conduction
- rinseable dirt filter
- connection thread G ½
- connection dimension: DN15
- suitable for continuous flow water heaters
- suitable for rim-/ tile-mounted mixers
- ACS 18 ACC LY 872, valide jusqu'au 07.02.2024
- REG 4 181350

#### Technology



#### Product image



#### Scale drawing

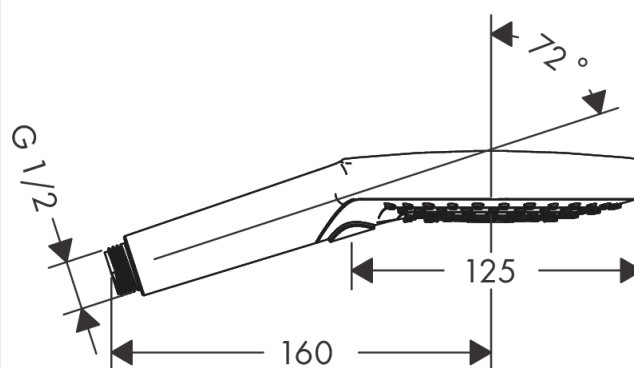

## AXOR ShowerSolutions

### Hand shower 120 3jet

Surfaces: **Chrome** Article Number: **26050000**



## Flowchart

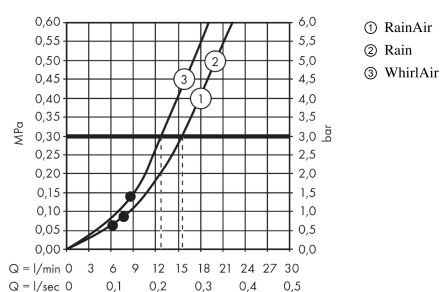

The consumption was measured in combination with the appropriate fittings (thermostat/mixer/in-wall valve) to reflect actual application in practice.

## AXOR ShowerSolutions

### Hand shower 120 3jet

Surfaces: **Chrome** Article Number: **26050000**



## Exploded Drawing

Year of production: >11/16

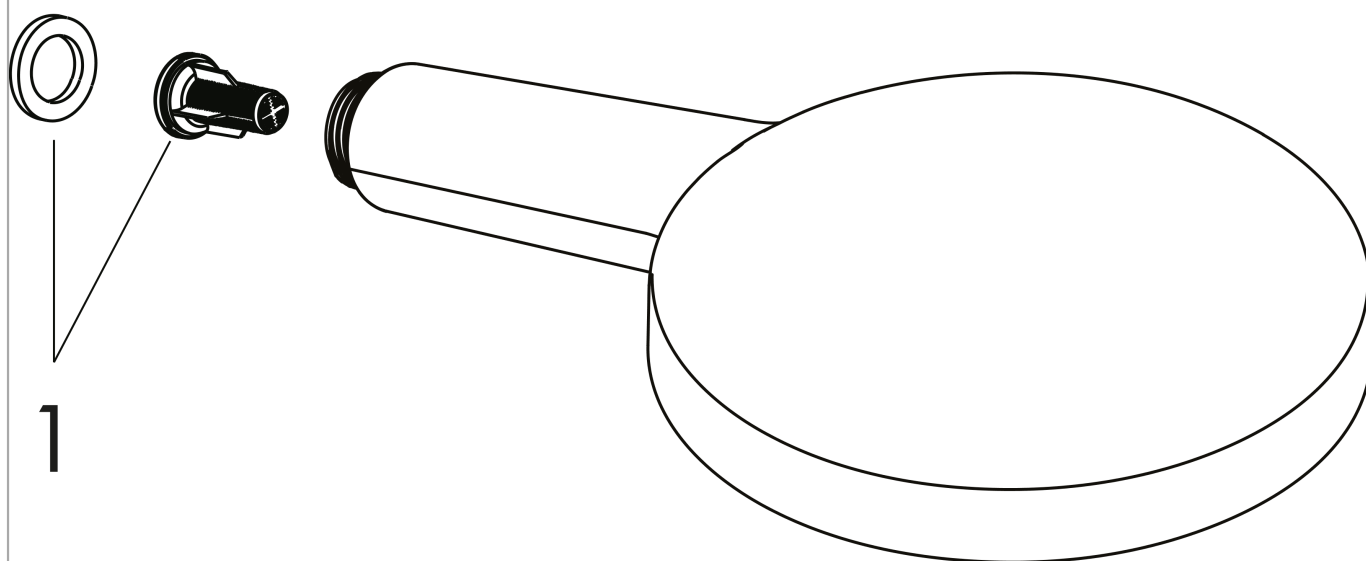

## AXOR ShowerSolutions

### Hand shower 120 3jet

Surfaces: **Chrome** Article Number: **26050000**



## Spare part list

Year of production: >11/16

Pos.	Description	Article Number	PC	PU
1	filter insert	97708000	0	1
2	pivoting connection	93089000	0	1