

AXOR ShowerSolutions
Flood spout 240/120 for concealed installation
 Surfaces: **Chrome** Article Number: **10942000**



Description

product features

- projection 180 mm
- when positioning the spout between waterconducting parts (no.10751000, no.10755000, no.10972000, no.10651000, no.28491000, no.40872000, no.40873000) in joined installation (10 mm distance) it is recommended to use basic set no.10941180
- can be used as bath spout or flood shower
- flow rate: 24 l/min
- connection dimension: device connection DN20
- spray type: wide flood jet
- ACS 16 ACC LY 618, valide jusqu'au 05.12.2021
- WRAS 1809007
- WRAS 1809007

Technology



Product image



Scale drawing

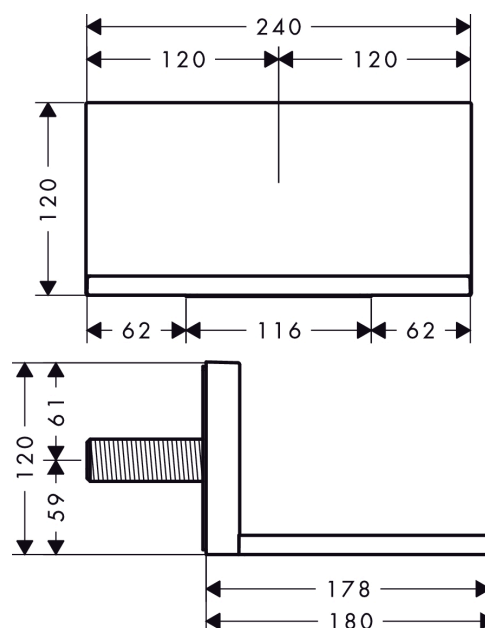

AXOR ShowerSolutions
Flood spout 240/120 for concealed installation
 Surfaces: **Chrome** Article Number: **10942000**



Flowchart

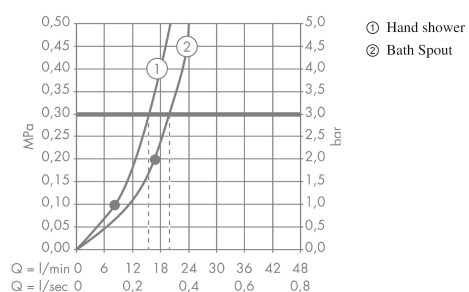

AXOR ShowerSolutions
Flood spout 240/120 for concealed installation
 Surfaces: **Chrome** Article Number: **10942000**



Exploded Drawing

Year of production: >11/11

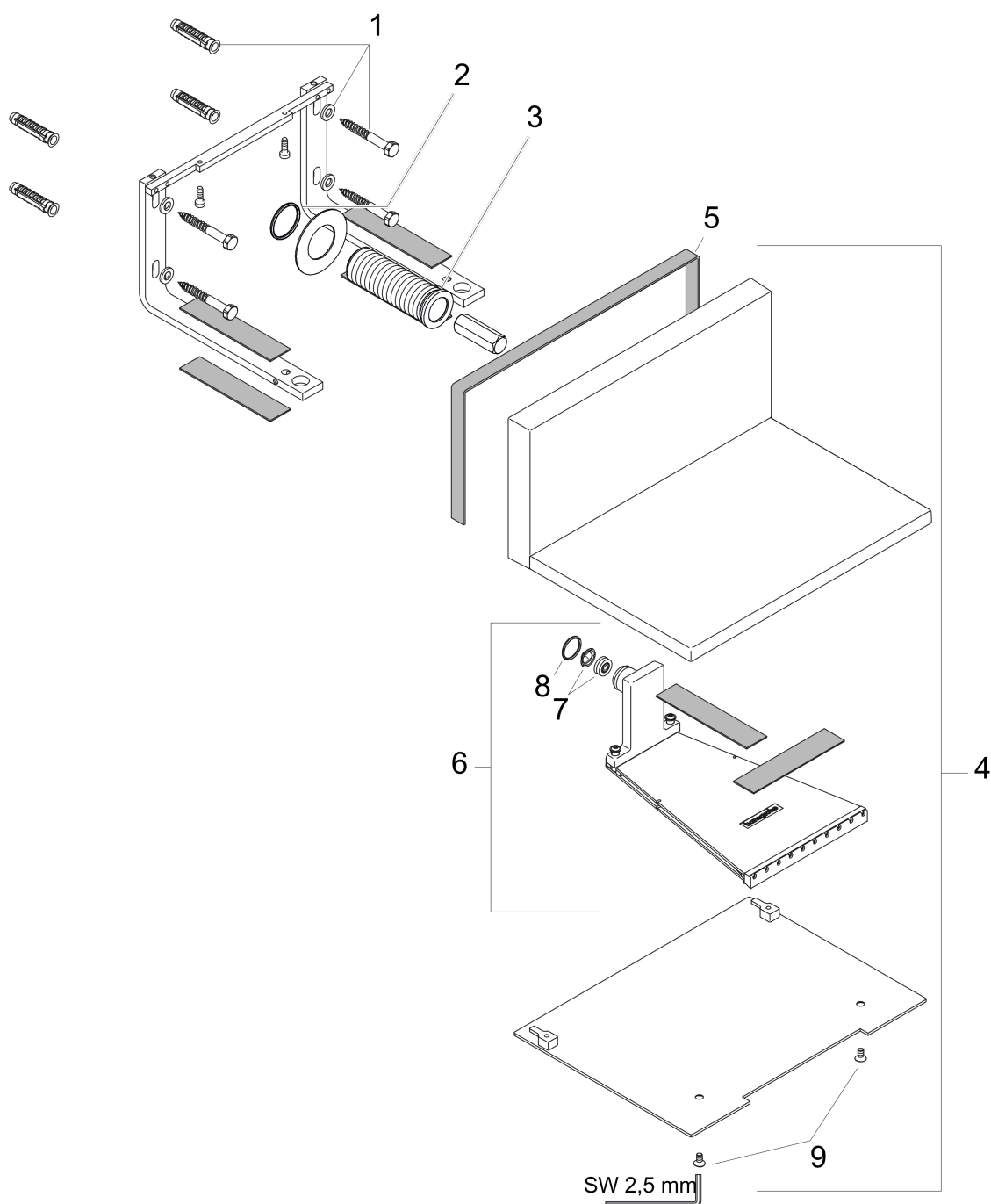

AXOR ShowerSolutions
Flood spout 240/120 for concealed installation
 Surfaces: **Chrome** Article Number: **10942000**



Spare part list

Year of production: >11/11

Pos.	Description	Article Number	PC	PU
1	mounting kit	95430000	0	1
2	O-ring 24x2	98388000	0	1
3	connecting thread G $\frac{3}{4}$	95886000	0	1
4	spout cpl.	95882000	0	1
5	seal	95885000	0	1
6	spray former	95883000	0	1
7	flow limiter (22 l/min)	95884000	0	1
8	O-ring 15x1,5	92118000	0	1
9	set of screws	92834000	0	1
a	-	10941180	0	1
b	spray former (special 8°)	95492000	0	1